

## REASSEMBLY

### HINT:

Before installing the parts, coat them with MP grease while referring to the components.

1. **INSTALL RECLINING CONNECTING PIPE**
2. **INSTALL SLIDE MOTOR SUPPORT BRACKET**

Install the support bracket with 4 bolts.

**Torque: 19 N·m ( 195 kgf·cm, 14 ft·lbf)**

3. **INSTALL FRONT SEAT INNER BELT**

Install the inner belt with nut.

**Torque: 42 N·m ( 430 kgf·cm, 31 ft·lbf)**

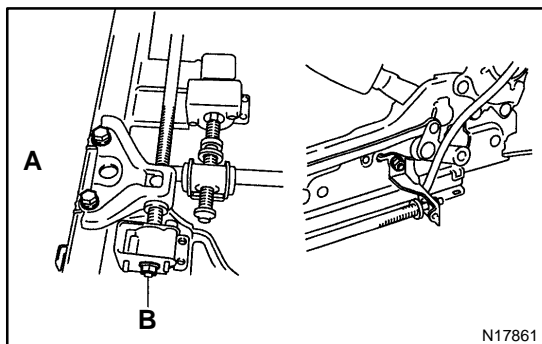

4. **INSTALL SEAT SUPPORT SCREW**

- (a) Install the support screw with the 2 bolts and 2 nuts.

**Torque:**

**A bolt: 25 N·m ( 260 kgf·cm, 19 ft·lbf)**

**B nut: 4.4 N·m ( 45 kgf·cm, 39 ft·lbf)**

### HINT:

Apply adhesive to the nut.

**Part No. 08833-00070, THREE BOND 1324 or equivalent**

- (b) Employ the same manner described above to the other side.

5. **INSTALL RECLINING MOTOR**

Install the motor with 3 screws.

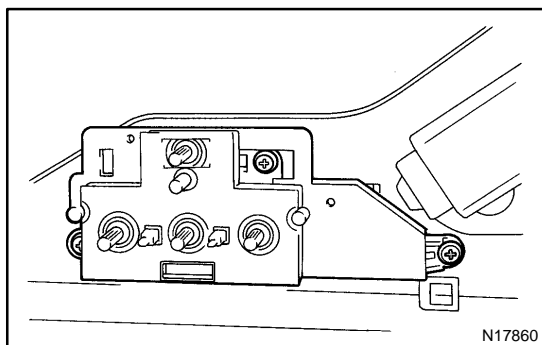

6. **INSTALL POWER SEAT SWITCH**

Install the power seat switch with the 3 screws.

7. **INSTALL VERTICAL MOTOR**

Install the vertical motor with the 2 screws.

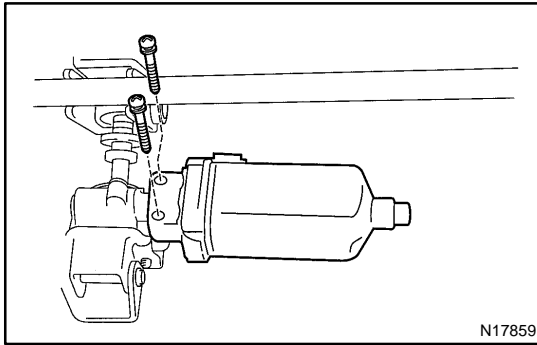
**8. INSTALL SLIDE MOTOR**

- (a) Connect the drive cable.
- (b) Install the slide motor with 2 screws.

**HINT:**

When installing the slide motor, tighten both the left and right seat slide screws equally.

**9. INSTALL WIRE HARNESS**

- (a) Install the wire harness to the seat adjuster.
- (b) Connect the connectors.

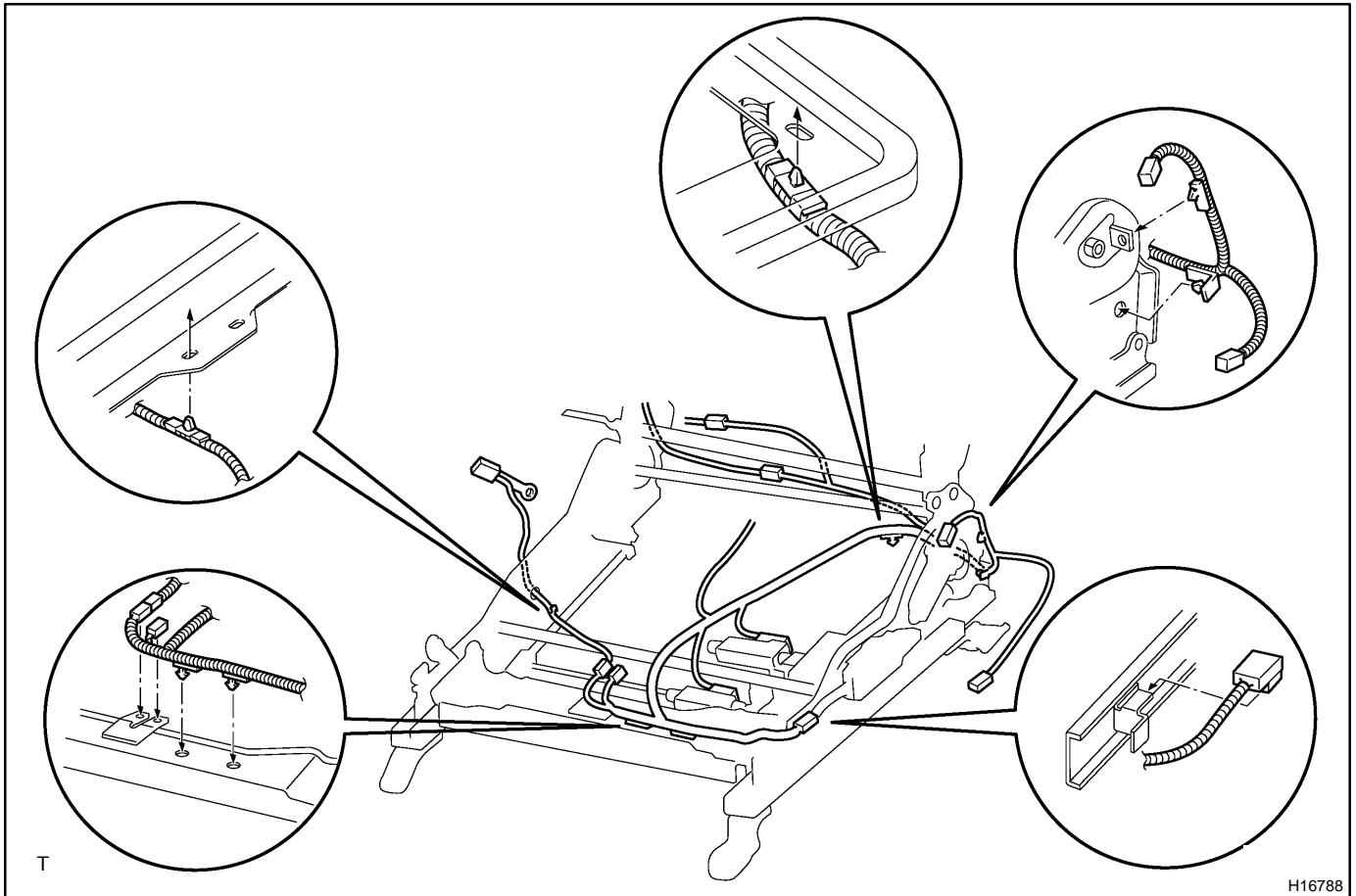
**10. INSTALL OUTSIDE INNER SHIELD****11. INSTALL INSIDE INNER SHIELD****12. INSTALL SEAT CUSHION COVER**

- (a) Install the seat cushion cover with new hog rings to seat cushion pad.
- (b) Install the silencer to the seat cushion frame.
- (c) Install the seat cushion cover with pad to the seat cushion frame with new hog rings.

**HINT:**

Install the hog rings to prevent wrinkles as least as possible.

**13. INSTALL SEAT CUSHION ASSEMBLY**

Install the seat cushion assembly with the 4 bolts to the seat.

**Torque: 18 N·m (185 kgf-cm, 13 ft-lbf)**

**HINT:**

Tighten the 4 bolts temporarily, then from the bolts on the rear side tighten completely.

**14. INSTALL SEATBACK COVER**

- (a) Install the lumbar support assembly with the 2 bolts to the seatback pad.
- (b) Driver's seat:  
Install the lumbar support assembly with the 2 bolts to the seatback frame.
- (c) Install the seatback cover with pad to the seatback frame.
- (d) Install the headrest supports.

**15. INSTALL SEATBACK ASSEMBLY**

- (a) Install the 4 bolts temporarily, then from the bolt on the front right side tighten completely.

**Torque: 43 N·m (440 kgf·cm, 32 ft·lbf)**

- (b) Engage the hooks.

**16. INSTALL SEAT CUSHION SHIELD RH**

Install the seat cushion shield RH with the 2 screws.

**17. INSTALL SEAT CUSHION SHIELD LH**

Install the lumbar support switch with the 2 screws to the seat cushion shield LH.

**18. INSTALL POWER SEAT SWITCH KNOBS****19. INSTALL HEADREST**